

# CORD

by panconnect•

**CORD** offers a smart solution for places where cables are needed but sockets are not. This panel replaces cable grommet and brings effective cable management to the meeting rooms, huddle rooms and workplaces. Installation is easy and quick, it fits to 100 mm holes.

**CORD** is produced in two variants - **CORD STANDARD** and **CORD POWER**. **CORD POWER** contains active **USB charging** (USB-A and 60 W USB-C) and two **pull - out cables**. **CORD STANDARD** is ready for placing up to 4 cables. **PULL-OUT** sys-

tem is a preferred option for cable manipulation that works on principle of gravity weighted cables in a textile bag and it allows the cable to be pulled up to 96 cm (the total length of the cable is 200 cm).

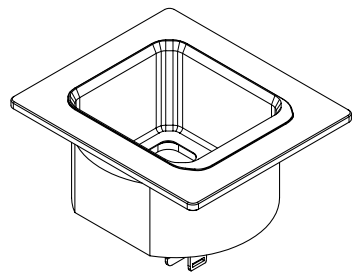

**STANDARD**

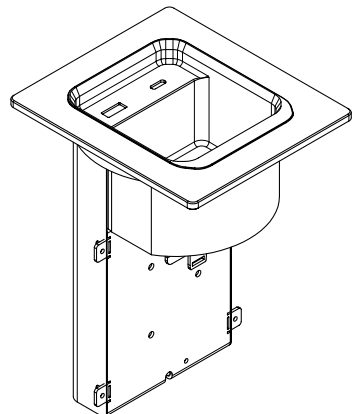

**POWER**

DIMENSIONS	WEIGHT	PULL-OUT CABLE SYSTEM	DIMENSIONS WITH PULL-OUT CABLE SYSTEM
110 × 126 × 74,5 mm	570 g	4	110 × 126 × 695 mm
110 × 126 × 168,5 mm	1190 g	2	110 × 126 × 695 mm

# CORD

by panconnect•

## STANDARD

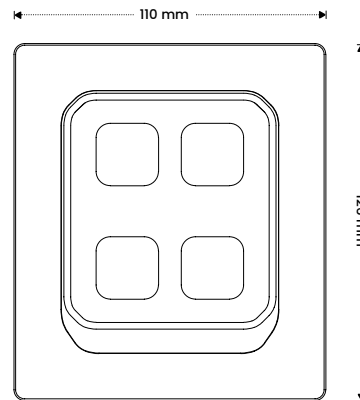

## POWER

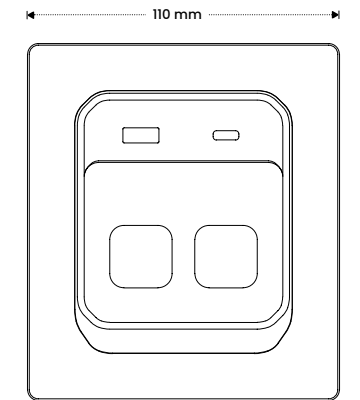

### POWER CABLE

**WAGO**  
miniWINSTA



**25 cm long pigtail**  
cable with WINSTA mini plug  
2+PE wiring | 10A

**WIELAND**  
GST18



**25 cm long pigtail**  
cable with GST18i3  
plug 2+PE wiring | 10A

**POWER**  
SUPPLY



cable with standard plug type  
a cable length **1,9 to 4,9m**) -  
**not available for all standards**

### PACKAGE CONTAINS

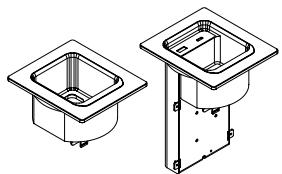

1 × panel CORD STANDARD / POWER  
with chosen power supply

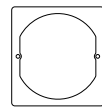

1 × mounting frame



2 × mounting screws in 6 possible sizes  
(depending on the the desk mounting height)

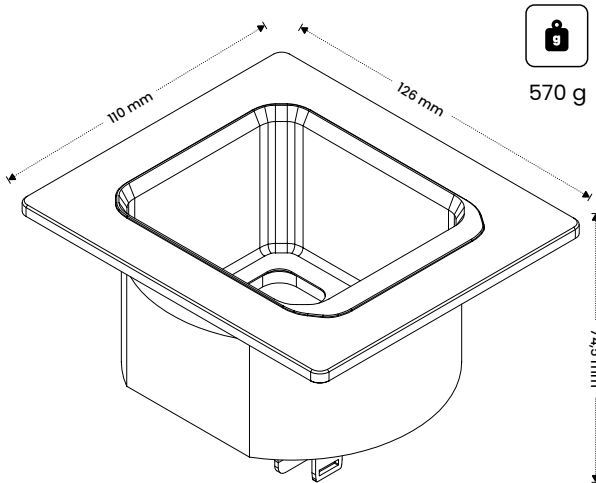

570 g

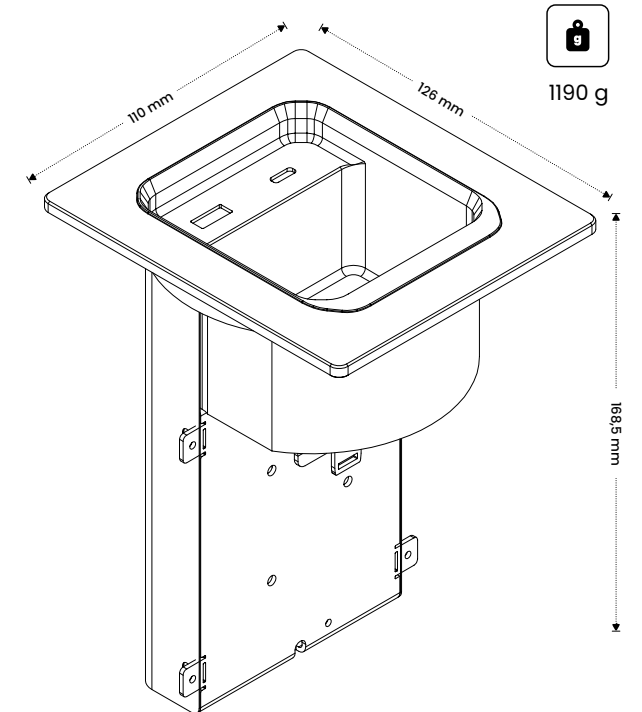

1190 g

### COLOURS



black



white



silver

# PULL-OUT SYSTEM

by panconnect•

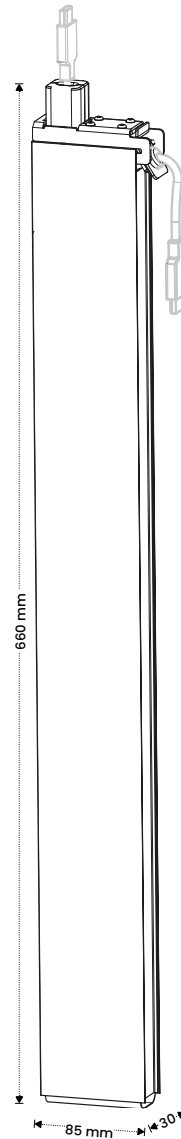

**PULL-OUT** - mechanism that works on the principle of gravity weighted cables in a textile bag and it allows the cable to be pulled up to 96 cm (the total length of the cable is 200 cm).

## WEIGHT

SIZE S

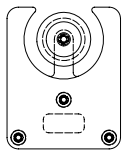

260 g

SIZE M

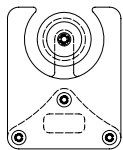

360 g

SIZE L

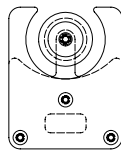

460 g

## PACKAGE CONTAINS

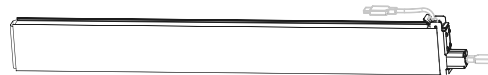

1 x pull-out system

## CABLES

USB-C 3.2 (M-M)

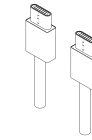

USB-C 3.2 gen 1  
5Gbps | 200cm  
gold and nickel plated  
black pvc

USB-C 3.2 (M-F)

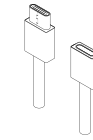

USB-C 3.2 gen 1  
5Gbps | 200cm  
gold and nickel plated  
black pvc

USB-C (M) / HDMI (M)

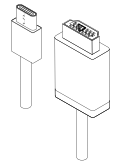

HDMI2.0 | 4K60Hz  
200cm  
gold-plated  
AWG32 / 22 | black pvc

mini DISPLAY PORT (M) / HDMI (M)

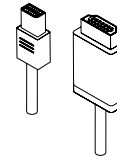

DP | 4K30Hz  
200cm  
4K/UHD/2160p@60Hz  
black pvc

DISPLAY PORT (M-M)

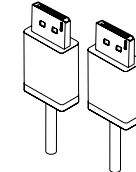

DPI.4 | 8K60Hz  
200cm  
gold-plated  
AWG32 / 22 | black pvc

DISPLAY PORT (M) / HDMI (M)

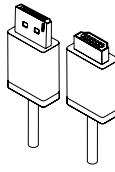

2K DP | WUXGA (1920x1200)  
200cm  
SECURE LOCK | gold-plated  
AWG28 | black pvc

HDMI (M-M)

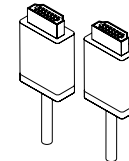

HDMI.4 | 4K30Hz  
200cm  
gold-plated | AWG32 / 22  
black pvc

HDMI (M-F)

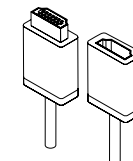

HDMI.4 | 4K30Hz  
200cm  
gold-plated | AWG32 / 22  
black pvc

USB 3.0 (M-F)

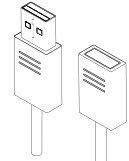

USB3.0 | 5Gbps  
200cm  
9pin  
AWG28/28 | black pvc

LAN (M-M)

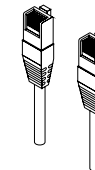

CAT6 RJ45 | UTP  
200cm  
CU 4x2  
AWG26/7 | black pvc

# SAFETY & RECYCLATION



PANCONNECT declares that panel CORD complies with Low voltage directive 2014/35/EC and EMC directive 2014/30/EU. Testing has been made according to EN 50491-5-1:2010 and EN 50491-5-2:2010 standards.



All products from PANCONNECT are intended for **upgrade** or **recyclation** in accordance with the company's policy.



Before the disposal of this panel comes up, please verify if this product can or cannot be upgraded or overhauled. If it's not possible, kindly arrange the disposal in accordance with valid EU directives. This product belongs to WASTE ELECTRICAL AND ELECTRONIC EQUIPMENT (WEEE) category so the disposal is possible only in accordance with this WEEE Directive 2012/19/EU. It cannot be part of the municipal waste.

**For more information please check**  
[www.asekol.cz](http://www.asekol.cz) | [info@asekol.cz](mailto:info@asekol.cz)

## USB-C SPECIFICATION

PowerDelivery up to 60W

## USB-A SPECIFICATION

QuickCharge 3.0 up to 5A

## SOCKETS

230V/10A (EU), 110V/10A (US)

## INGRESS PROTECTION

IP22

## POWER SUPPLY

110 - 250V, 10A

## MODULARITY

PULL-OUT

## MATERIALS

Dural | stainless steel | FENIX NTM | cortexin

## DESIGNER

Dominik Hutečka

## INSTALLATION MANUAL

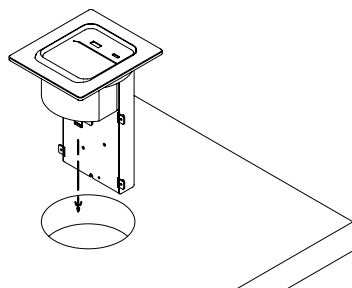

**DESK MOUNTING HEIGHT**  
10 mm  
up to 40 mm  
(up to 60 mm with custom screws)

**Tools: hole saw Ø 100 mm and screwdriver**

- 01| Mark the centers and cut the holes with the hole saw
- 02| Put the panel into the cutout
- 03| Place the frame from the bottom part of the panel and tighten the screws
- 04| Clip on the pull out, plug it in and the panel is ready

Designed & manufactured in Brno, Czech Republic.  
PANCONNECT s.r.o. | Olomoucká 51, Brno | Czech Republic  
[www.panconnect.eu](http://www.panconnect.eu) | [support@panconnect.eu](mailto:support@panconnect.eu)

**panconnect**