

CORD

by panconnect•

CORD offers a smart solution for places where cables are needed but sockets are not. This panel replaces cable grommet and brings effective cable management to the meeting rooms, huddle rooms and workplaces. Installation is easy and quick, it fits to 100 mm holes.

CORD is produced in two variants - **CORD STANDARD** and **CORD POWER**. **CORD POWER** contains active **USB charging** (USB-A and 60 W USB-C) and two **pull - out cables**. **CORD STANDARD** is ready for placing up to 4 cables. **PULL-OUT** sys-

tem is a preferred option for cable manipulation that works on principle of gravity weighted cables in a textile bag and it allows the cable to be pulled up to 96 cm (the total length of the cable is 200 cm).

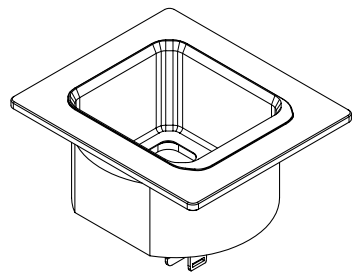

STANDARD

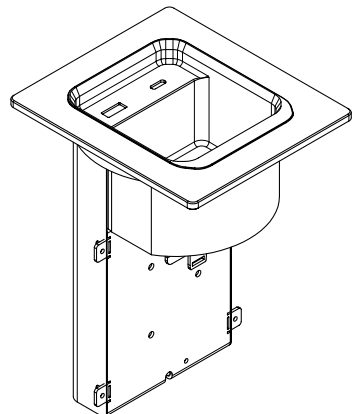

POWER

DIMENSIONS	WEIGHT	PULL-OUT CABLE SYSTEM	DIMENSIONS WITH PULL-OUT CABLE SYSTEM
110 × 126 × 74,5 mm	570 g	4	110 × 126 × 695 mm
110 × 126 × 168,5 mm	1190 g	2	110 × 126 × 695 mm

CORD

by panconnect•



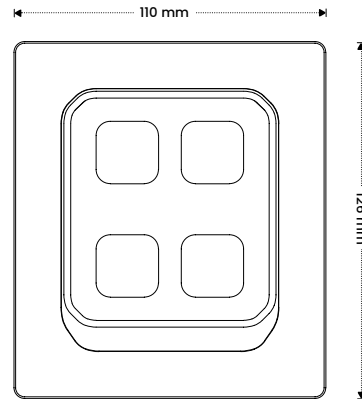

STANDARD



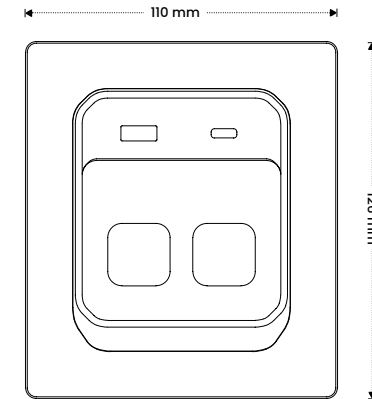

POWER



POWER CABLE

WAGO miniWINSTA 	WIELAND GST18 	POWER SUPPLY 
25 cm long pigtail cable with WINSTA mini plug 2+PE wiring 10A	25 cm long pigtail cable with GST18i3 plug 2+PE wiring 10A	cable with standard plug type a cable length 1,9 to 4,9m - not available for all standards

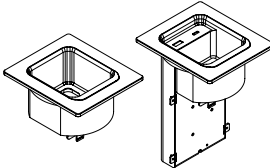
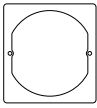
PACKAGE CONTAINS

 1 × panel CORD STANDARD / POWER with chosen power supply	 1 × mounting frame  2 × mounting screws in 6 possible sizes (depending on the the desk mounting height)
--	--

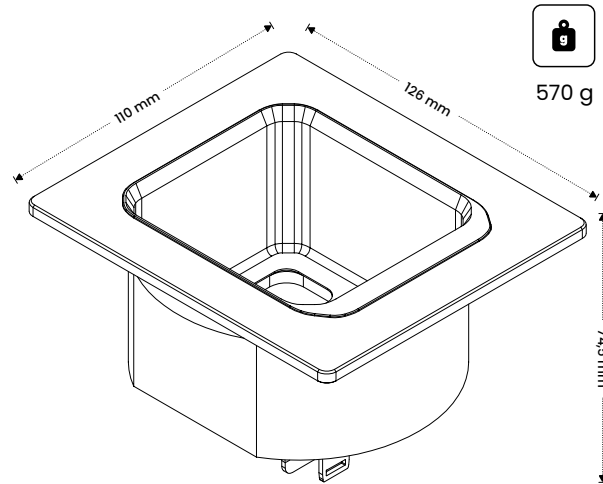

570 g

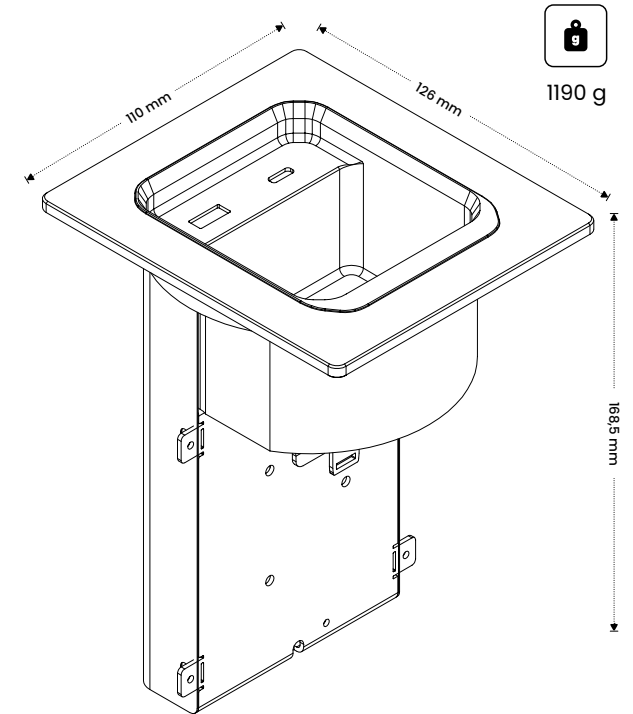

1190 g

COLOURS



black



white



silver

PULL-OUT SYSTEM

by panconnect•

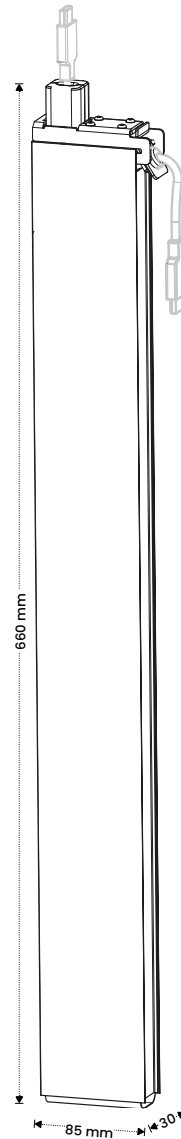

PULL-OUT - mechanism that works on the principle of gravity weighted cables in a textile bag and it allows the cable to be pulled up to 96 cm (the total length of the cable is 200 cm).

WEIGHT

SIZE S

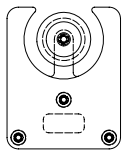

260 g

SIZE M

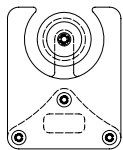

360 g

SIZE L

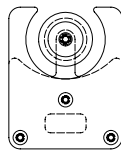

460 g

PACKAGE CONTAINS

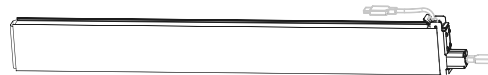

1 x pull-out system

CABLES

USB-C 3.2 (M-M)

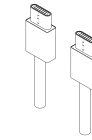

USB-C 3.2 gen 1
5Gbps | 200cm
gold and nickel plated
black pvc

USB-C 3.2 (M-F)

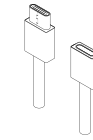

USB-C 3.2 gen 1
5Gbps | 200cm
gold and nickel plated
black pvc

USB-C (M) / HDMI (M)

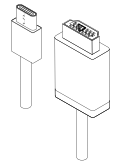

HDMI2.0 | 4K60Hz
200cm
gold-plated
AWG32 / 22 | black pvc

mini DISPLAY PORT (M) / HDMI (M)

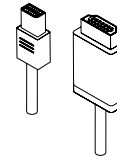

DP | 4K30Hz
200cm
4K/UHD/2160p@60Hz
black pvc

DISPLAY PORT (M-M)

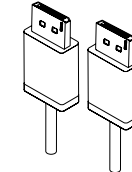

DPI.4 | 8K60Hz
200cm
gold-plated
AWG32 / 22 | black pvc

DISPLAY PORT (M) / HDMI (M)

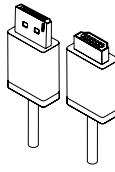

2K DP | WUXGA (1920x1200)
200cm
SECURE LOCK | gold-plated
AWG28 | black pvc

HDMI (M-M)

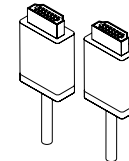

HDMI.4 | 4K30Hz
200cm
gold-plated | AWG32 / 22
black pvc

HDMI (M-F)

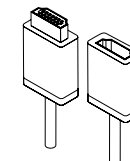

HDMI.4 | 4K30Hz
200cm
gold-plated | AWG32 / 22
black pvc

USB 3.0 (M-F)

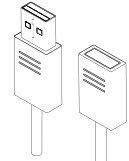

USB3.0 | 5Gbps
200cm
9pin
AWG28/28 | black pvc

LAN (M-M)

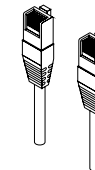

CAT6 RJ45 | UTP
200cm
CU 4x2
AWG26/7 | black pvc

SAFETY & RECYCLATION



PANCONNECT declares that panel **CORD** complies with Low voltage directive 2014/35/EC and EMC directive 2014/30/EU. Testing has been made according to EN 50491-5-1:2010 and EN 50491-5-2:2010 standards.



All products from **PANCONNECT** are intended for **upgrade** or **recyclation** in accordance with the company's policy.



Before the disposal of this panel comes up, please verify if this product can or cannot be upgraded or overhauled. If it's not possible, kindly arrange the disposal in accordance with valid EU directives. This product belongs to WASTE ELECTRICAL AND ELECTRONIC EQUIPMENT (WEEE) category so the disposal is possible only in accordance with this WEEE Directive 2012/19/EU. It cannot be part of the municipal waste.

For more information please check
www.asekol.cz | info@asekol.cz

INSTALLATION MANUAL

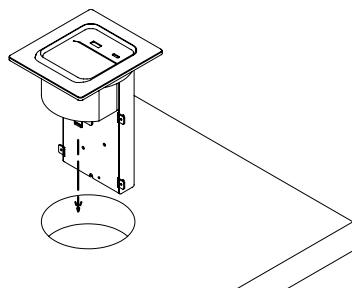
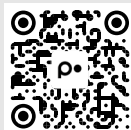

DESK MOUNTING HEIGHT
10 mm
up to 40 mm
(up to 60 mm with custom screws)

Tools: hole saw Ø 100 mm and screwdriver

- 01** Mark the centers and cut the holes with the hole saw
- 02** Put the panel into the cutout
- 03** Place the frame from the bottom part of the panel and tighten the screws
- 04** Clip on the pull out, plug it in and the panel is ready

USB-C SPECIFICATION

PowerDelivery up to 60W

USB-A SPECIFICATION

QuickCharge 3.0 up to 5A

SOCKETS

230V/10A (EU), 110V/10A (US)

INGRESS PROTECTION

IP22

POWER SUPPLY

110 - 250V, 10A

MODULARITY

PULL-OUT

MATERIALS

Dural | stainless steel | FENIX NTM | cortexin

DESIGNER

Dominik Hutečka

Designed & manufactured in Brno, Czech Republic.
PANCONNECT s.r.o. | Olomoucká 51, Brno | Czech Republic
www.panconnect.eu | support@panconnect.eu

panconnect